

Solstice Univ. Shoe Box Plate [75W-135W Universal Shoe Box Kit]



Minimum Fixture
Dimensions:
14.25"x14.5"

Maximum Fixture
Dimensions:
27"x 26.75"



*Available in stock-able packaging

Description and Application:

The new Global Tech LED Universal Plates are an innovative solution which solves the issue of needing a custom plate. With these new plate systems a range of fixture sizes can be retrofit using the same universal plate kit. This Universal Flood Plate features one Solstice LED module, Driver, Plate, and fully adjustable arms.

Key Features:

- Patented Life Sync Technology - Lumen depreciation maintenance, over temperature protection
- Soft start
- 0-10VDC Dimming compatible
- 0-10VDC Input port

4 Wattage Selection of Switch:

GTSOL5498 – 75W, 85W, 95W, 135W

Driver and Wattage:

50/60Hz

Input voltage 120-277VAC 100W

347-480VAC 100w driver also available.

24VDC operation without driver.

150W drivers available for HO (HO = 135 Watts.)

Additional Information:

Operating Temperature Range:
-40°C to 55°C Nominal

Photometrics:
.ies files available

Optics offered for different distributions.
(Dist. = 120° w/o secondary optics)

Surge Protector:
- Required for ALL 347V-480V applications in order to qualify for Warranty
- Recommended for all outdoor applications

L70 > 150,000Hrs.

Life Sync adjusts module to operate at max performance in any given environment

Warranty: Driver = 5 years
Solstice Light Engine = 10 years

LED Module Compatibility

Product	Output Setting	LED Chip Drive Current [mA]	Rated Lumens [Lm]	Rated Watts [W]
GTSOL5498 x 1	HO	900	13164	135
GTSOL5498 x 1	HI	700	9447	95
GTSOL5498 x 1	MH	525	8999	85
GTSOL5498 x 1	ML	350	7814	75

Accessories

Catalog #	Description
IP67	IP67 Rated LED Engine
GT-LSP-120	Surge Protector. 120 V 10 kA Parallel. 20kA maximum discharge current.
GT-LSP-240	Surge Protector. 240 V 10 kA Parallel. 20kA maximum discharge current.
GT-LSP-277	Surge Protector. 277 V 10 kA Parallel. 20kA maximum discharge current.
GT-LSP-347	Surge Protector. 347 V 10 kA Parallel. 20kA maximum discharge current.
GT-LSP-480	Surge Protector. 480 V 10 kA Parallel. 20kA maximum discharge current.



Fully Compliant with ARRA Buy American Requirements. Made in the USA.



Pricing Information

Solstice Univ. Shoe Box Plate [75W-135W Universal Shoe Box Kit]

SR16-6R1

Details

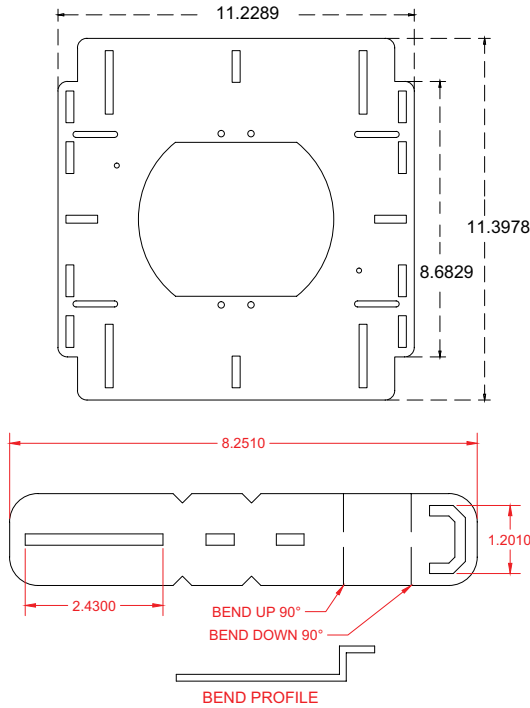

Minimum Fixture Dimensions:
14.25"x14.5"

Maximum Fixture Dimensions:
27"x 26.75"

Features



- Life Sync
- Module Temp Protection
- Lumen Depreciation Maintenance
- Wattage Selections (on board)
- On Board Programming
- 5-6-1 Energy Saving Program
- 0-10V Dimming
- Lumiled Luxeon LED chips
- Active Thermal Management
- Optical Distribution Options
- -40°C to 55°C Nominal Operating Temperature
- 10 Year Warranty

Ordering Code Example:

GTR - AR - 5498 - HI - SV - GR - NL - UVSB / IP67

Retrofit	Category	Module	Wattage	Voltage	CCT	Lens	Mounting Method	Accs
GTR	AR = Area/Roadway	5498	HO (135W)	SV (120V-277V)	GR (5000K) [70CRI]	NL = No Lens	UVSB = Universal Shoe Box	IP67 = 5498*
	HB = High Bay		HV (347V-480V)	BR (5000K) [80CRI]	10D = 10D Lens	GT-LSP-120		
	WP = Wall Pack	5498	HI (95W)	SV (120V-277V)	YW (4100K) [70CRI]	25D = 25D Lens		GT-LSP-240
	PG = Parking Garage		HV (347V-480V)	BL (4000K) [80CRI]	50D = 50D Lens	GT-LSP-277		
	FC = Fuel Canopy	5498	MH (85W)	SV (120V-277V)	RD (3500K) [80CRI]	75D = 75D Lens		GT-LSP-347
	PT = Post Top		HV (347V-480V)	PR (3000K) [95CRI]	360D = 360D Lens	GT-LSP-480		
	HZ = Hazardous	5498	ML (75W)	SV (120V-277V)	OR (2700K) [80CRI]	360s = 360 Square Lens		
	BD = Bollard			HV (347V-480V)	GRO (Grow)†	T2 = Type II Lens		
	TB = Tube				AMB (Amber)†	T3 = Type III Lens		
	SI = Screw In				AQU (Aquarium)†			
GW = Horticulture				RYB (Royal Blue)†				

* IP67 upgrade for module + fan (only NL, 10D, 25D, 50D & 75D)
+ Upcharges not included in MSRP Price

Please see previous page for accessory information
Please note, prices may change with quantity

Fully Compliant with ARRA Buy American Requirements. Made in the USA.