

# GTL-WP-SM303

## [30W-135W LED Wall Pack Fixture]

**Description:**

Ideal for building, back yards, parks, signs, sports field, parking lots and other general applications where floodlighting may come into use.

**Specification Features:**

- CSA listed for damp locations.
- Custom colors available upon request.
- Specifications subject to change without notice.

**Input Voltage:**

120-277VAC driver input.

347-480VAC driver available.

Without driver modules runs on 24VDC.

**Housing:**

- Heavy duty die-cast aluminum
- Powder coating
- Heat and impact resistant tempered glass lens
- Dark architectural bronze color
- Powder coated finish on the heavy duty die cast housing
- Silicone rubber included to prevent any leakage from the outside

**LED Module Compatibility**

Product	Output Setting	LED Chip Drive Current [mA]	Rated Lumens [Lm]	Rated Watts [W]
GTSOL5498 x 1	HO	900	13164	135
GTSOL5498 x 1	HI	700	9447	95
GTSOL5498 x 1	MH	525	8999	85
GTSOL5498 x 1	ML	350	7814	75
GTSOLM21 x 1	HI	700	5910	60
GTSOLM21 x 1	MH	600	4594	50
GTSOLM21 x 1	ML	500	3742	40
GTSOLM21 x 1	LO	400	2679	30

**Additional Information:**

Operating Temperature Range:  
-40°C to 55°C Nominal

Photometrics:  
.ies files available

Optics offered for different distributions.  
(Dist. = 120° w/o secondary optics)

Surge Protector:  
- Required for ALL 347V-480V applications in order to qualify for Warranty  
- Recommended for all outdoor applications

L70 > 150,000Hrs.

Life Sync adjusts module to operate at max performance in any given environment

Warranty: Driver = 5 years  
Solstice Light Engine = 10 years  
Fixture = 10 years

**Accessories**

Catalog #	Description
IP67	IP67 Rated LED Engine
GT-LSP-120	Surge Protector. 120 V 10 kA Parallel. 20kA maximum discharge current.
GT-LSP-240	Surge Protector. 240 V 10 kA Parallel. 20kA maximum discharge current.
GT-LSP-277	Surge Protector. 277 V 10 kA Parallel. 20kA maximum discharge current.
GT-LSP-347	Surge Protector. 347 V 10 kA Parallel. 20kA maximum discharge current.
GT-LSP-480	Surge Protector. 480 V 10 kA Parallel. 20kA maximum discharge current.

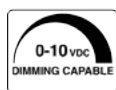
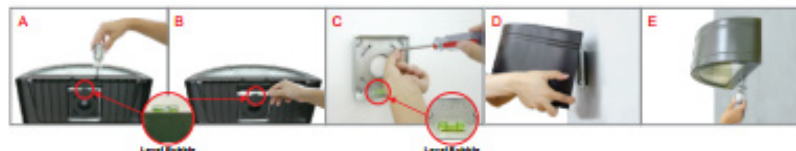

**Fully Compliant with ARRA Buy American Requirements. Made in the USA.**



# Pricing Information

## GTL-WP-SM303 [30W-135W LED Wall Pack Fixture]

SR16-6R1

### Details

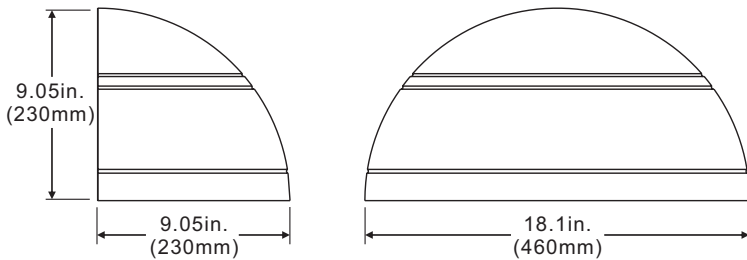

### Features



- Life Sync
- Module Temp Protection
- Lumen Depreciation Maintenance
- Wattage Selections (on board)
- On Board Programming
  - 5-6-1 Energy Saving Program
  - 0-10V Dimming
- Lumiled Luxeon LED chips
- Active Thermal Management
- Optical Distribution Options
- -40°C to 55°C Nominal Operating Temperature
- 10 Year Warranty

### Ordering Code Example:

GTL-WP-SM303 - 5498 - ML - SV - PR - 360D / IP67 - GT-LSP-120

Fixture	Module	Wattage	Voltage		CCT	Lens	Accs	
<b>GTL-WP-SM303</b>	<b>5498</b>	<b>HO (135W)</b>	<b>SV (120V-277V)</b>		<b>GR (5000K) [70CRI]</b>	<b>NL = No Lens</b>	<b>IP67 = M21*</b>	
			<b>HV (347V-480V)</b>		<b>BR (5000K) [80CRI]</b>	<b>10D = 10D Lens</b>	<b>IP67 = 5498*</b>	
	<b>5498</b>	<b>HI (95W)</b>	<b>SV (120V-277V)</b>		<b>YW (4100K) [70CRI]</b>	<b>25D = 25D Lens</b>	<b>GT-LSP-120</b>	
			<b>HV (347V-480V)</b>		<b>BL (4000K) [80CRI]</b>	<b>50D = 50D Lens</b>	<b>GT-LSP-240</b>	
	<b>5498</b>	<b>MH (85W)</b>	<b>SV (120V-277V)</b>		<b>RD (3500K) [80CRI]</b>	<b>75D = 75D Lens</b>	<b>GT-LSP-277</b>	
			<b>HV (347V-480V)</b>		<b>PR (3000K) [95CRI]</b>	<b>360D = 360D Lens</b>	<b>GT-LSP-347</b>	
	<b>5498</b>	<b>ML (75W)</b>	<b>SV (120V-277V)</b>		<b>OR (2700K) [80CRI]</b>	<b>360s = 360 Square Lens</b>	<b>GT-LSP-480</b>	
			<b>HV (347V-480V)</b>		<b>GRO (Grow)†</b>	<b>T2 = Type II Lens</b>		
	<b>M21</b>	<b>HI (60W)</b>	<b>SV (120V-277V)</b>		<b>AMB (Amber)†</b>	<b>T3 = Type III Lens</b>		
			<b>HV (347V-480V)</b>		<b>AQU (Aquarium)†</b>			
	<b>M21</b>	<b>MH (50W)</b>	<b>SV (120V-277V)</b>		<b>RYB (Royal Blue)†</b>			
			<b>HV (347V-480V)</b>					
	<b>M21</b>	<b>ML (40W)</b>	<b>SV (120V-277V)</b>					
			<b>HV (347V-480V)</b>					
	<b>M21</b>	<b>LO (30W)</b>	<b>SV (120V-277V)</b>					
			<b>HV (347V-480V)</b>					

\* IP67 upgrade for module + fan (only NL, 10D, 25D, 50D & 75D)

† Upcharges not included in MSRP Price

Please see previous page for accessory information

Please note, prices may change with quantity

**Fully Compliant with ARRA Buy American Requirements. Made in the USA.**